

MEETING ROOMS

The Peoria Civic Center features 17,000 sq. ft. of meeting space in addition to the Ballroom. These 16 rooms are located on the first and second levels and vary in size with seating from 10 - 1,000 people with access available via stairs and elevators.

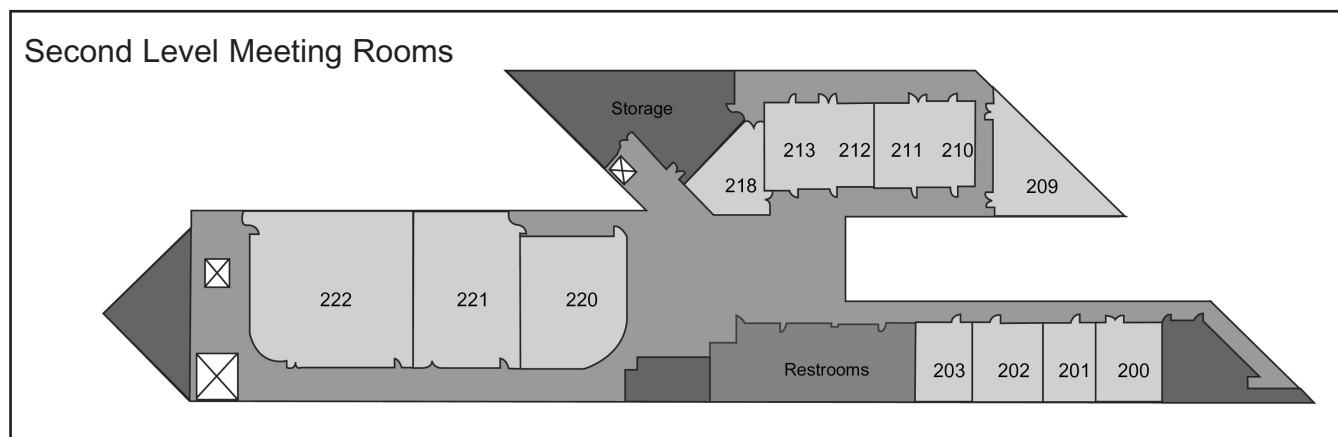
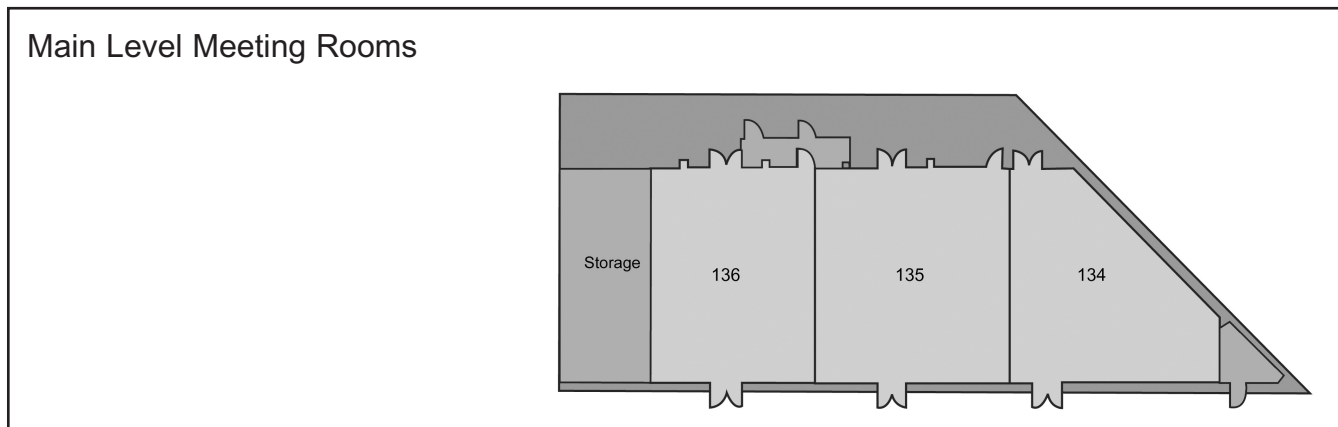

Lobbies

Skylight	3,424 sq. ft.	117 x 30
Triangle	2,383 sq. ft.	101 x 65
Terrazzo	3,932 sq. ft.	42 x 100
220 s Pre-function	1,500 sq. ft.	40 x 44

Event Services

The experienced Peoria Civic Center staff will coordinate every aspect of your event from decorators to floral services. All events can be turnkey. You are also allowed to bring in your preferred suppliers, with Peoria Civic Center approval.

Catering

Exclusive catering provided by Centerplate, our in-house caterer. Room rental rates may be reduced or waived depending on the amount of food and beverage purchased through Centerplate.

Audio Visual

Your complete audio visual equipment needs, including an AV specialist, are available. Some meetings rooms have special no glare finish, allowing for images to be projected onto the wall.

Security/ Emergency

The Peoria Civic Center provides full-service security that is arranged through your event manager. A certified nurse is required with events hosting 300 people or more.

Internet Access

We feature high-speed wireless Internet, Video Streaming, and Video Conferencing throughout our facilities.

Restrooms

Restrooms are conveniently located throughout the facilities.



MEETING ROOMS

Room	Floor Space	Width & Length	Height	Theater Capacity	Banquet Capacity	Classroom Capacity
134	1,200 sq. ft.	Triangular	14	126 people	72 people	90 people
135	1,500 sq. ft.	40 x 37 6	14	153 people	96 people	112 people
136	1,160 sq. ft.	40 x 29	14	110 people	64 people	70 people
135/136	2,660 sq. ft.	40 x 66 6	14	263 people	160 people	182 people

Room	Floor Space	Width & Length	Height	Theater Capacity	Banquet Capacity	Classroom Capacity
200	600 sq. ft.	25 x 24	9	63 people	40 people	45 people
201	490 sq. ft.	25 x 19 6	9	63 people	40 people	36 people
202	530 sq. ft.	20 x 26 6	9	54 people	32 people	38 people
203	525 sq. ft.	25 x 21	9	54 people	40 people	40 people
209	929 sq. ft.	Triangular	10	90 people	56 people	70 people
210	608 sq. ft.	32 x 19	10	63 people	48 people	46 people
211	608 sq. ft.	32 x 19	10	63 people	48 people	46 people
210/211	1,216 sq. ft.	32 x 38	10	126 people	96 people	91 people
212	608 sq. ft.	32 x 19	10	63 people	48 people	46 people
213	672 sq. ft.	32 x 21	10	63 people	48 people	51 people
212/213	1,280 sq. ft.	32 x 40	10	126 people	96 people	96 people
218	644 sq. ft.	Triangular	10	45 people	32 people	35 people
220	1,797 sq. ft.	39 8 x 48 6	10	197 people	96 people	99 people
221	2,181 sq. ft.	40 x 56 10	10	256 people	104 people	114 people
222	3,303 sq. ft.	60 7 x 56 10	10	385 people	224 people	204 people
220/221	3,978 sq. ft.	88 6 x 40	10	453 people	192 people	224 people
221/222	5,484 sq. ft.	100 7 x 56 10	10	641 people	320 people	300 people
220-222	7,289 sq. ft.	149 1 x 56 10	10	1,000 people	408 people	417 people

Included with your room rental are tables, chairs, initial room setup, energy, house sound, podium, and wired microphone. When the primary purpose of the event includes food service, basic white linens are also provided.

*Numbers reflect maximum capacity with podium in front of room. Additions will decrease capacities of staging.